



± **11,012**

PI. CA.
SQ. FT.

3521 THIMENS

VILLE ST-LAURENT, QC

CARACTÉRISTIQUES | SPECIFICATIONS

Superficie totale (pi. ca.) Total Area (sq. ft.)	± 11,012
Entrepôt (pi. ca.) Warehouse (sq. ft.)	± 8,570
Bureaux (pi. ca.) Office (sq. ft.)	± 2,442
Hauteur libre (pi) Clear Height (ft.)	17'
Quais de chargement Dock-Level Doors	2

Disponibilité | Availability

IMMEDIATE

À LOUER | FOR LEASE

BÂTIMENT INDUSTRIEL
INDUSTRIAL BUILDING

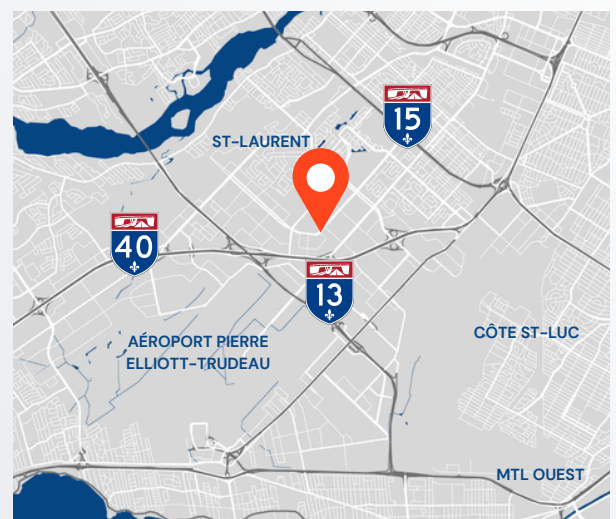

ACCÈS | ACCESS

Emplacement stratégique à proximité des
autoroutes 40, 13 et 15

Strategic location near Highways 40, 13 and 15

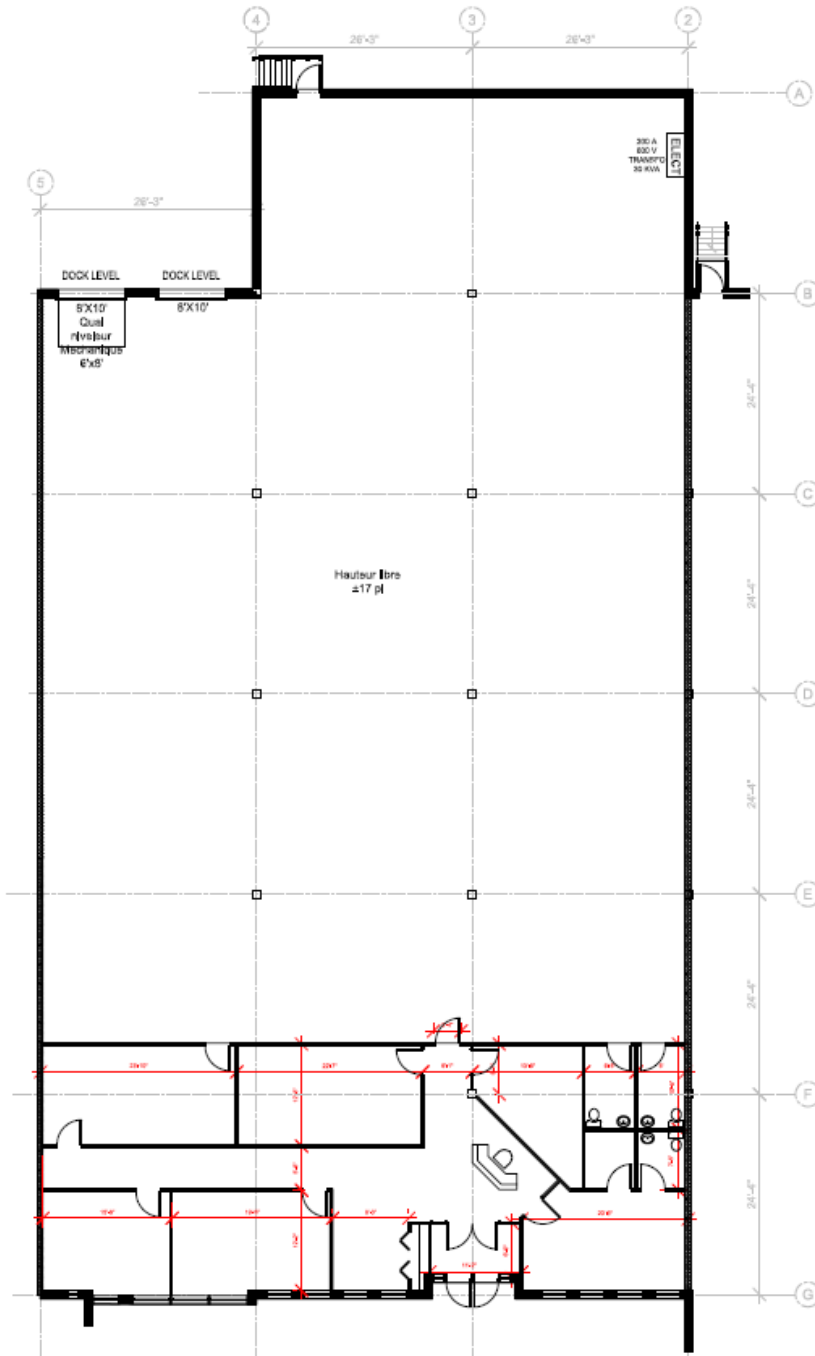

PLAN
FLOOR PLAN

Superficie totale (pi. ca.)
Total Area (sq. ft.)
± 11,012

Entrepôt (pi. ca.)
Warehouse (sq. ft.)
± 8,570

Bureaux (pi. ca.)
Office (sq. ft.)
± 2,442

À LOUER
FOR LEASE

3521
THIMENS
VILLE ST-LAURENT, QC

